

## 27 296 003 EUPHORIA SYSTEM 260 SHOWER SYSTEM WITH THERMOSTATIC MIXER FOR WALL MOUNTING

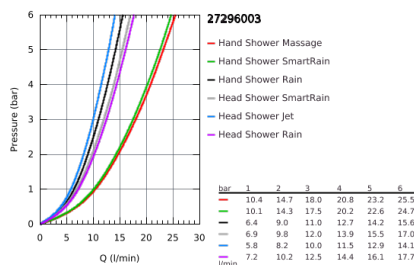
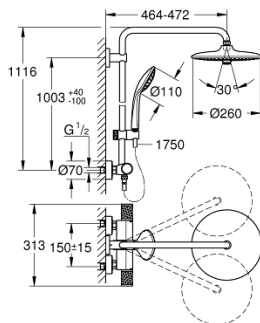

### PRODUCT DESCRIPTION

- Consisting of:
  - horizontal swivable 450 mm projection shower arm
  - exposed thermostatic shower with Aquadimmer function
  - allows change between:
    - head shower Euphoria 260 (26 455)
    - Rain, SmartRain, Jet
  - with ball joint
  - rotation angle  $\pm 15^\circ$
  - hand shower Euphoria 110 Massage (27 221 000)
  - 3 spray patterns:
    - Rain, Massage, SmartRain
  - adjustable height via gliding element
  - Silverflex shower hose 1750 mm (28 388 000)
  - GROHE TurboStat compact cartridge with wax thermoelement
  - GROHE SafeStop safety button at  $38^\circ\text{C}$  ( calibration required )
  - GROHE SafeStop Plus optional temperature limiter at  $43^\circ\text{C}$  included
  - GROHE CoolTouch prevents scalding on hot surfaces
  - GROHE ProGrip with knurl structure
  - GROHE DreamSpray perfect spray pattern
  - GROHE StarLight chrome finish
  - GROHE SprayDimmer (Stepless flow rate reduction)
  - GROHE FastFixation upper bracket adjustable
  - Inner WaterGuide for a longer life
  - SpeedClean anti-limescale system
  - Twistfree preventing the hose from twisting
  - suitable for instantaneous heaters from 18 kW/h
  - minimum flow rate 7 l/min.
  - optional upgrade: GROHE EasyReach tray (26 362)
- professional edition

## 27 296 003 EUPHORIA SYSTEM 260 SHOWER SYSTEM WITH THERMOSTATIC MIXER FOR WALL MOUNTING

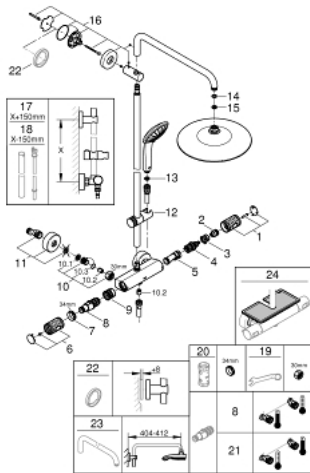

### SPARE PARTS, January 2020 – now

- 1: Shut-off handle (Order-nr. 49162000)
- 2: Stop ring (Order-nr. 47986000)
- 3: Stop ring (Order-nr. 47965000)
- 4: Aquadimmer (Order-nr. 47364000)
- 5: Water flow (Order-nr. 47887000)
- 6: Shut-off handle (Order-nr. 49160000)
- 7: retaining ring (Order-nr. 47743000)
- 8: Thermostatic compact cartridge 1/2" (Order-nr. 47439000)
- 9: Race (Order-nr. 47975000)
- 10: Non-return valve (Order-nr. 47189000)
- 10.1: Filter (Order-nr. 0726400M)
- 10.2: Non-return valve (Order-nr. 08565000)
- 10.3: O-Ring Ø17 x Ø2 (Order-nr. 0305500M)
- 11: S-union (Order-nr. 12662000)
- 12: Sliding piece (Order-nr. 48424000)
- 13: Strainer (Order-nr. 0700200M)
- 14: Fibre seal dia. Ø 18,5 x Ø 12 x 2 (Order-nr. 0138900M)
- 15: Strainer (Order-nr. 48007000)
- 16: Outlet shower holder (Order-nr. 48279000)
- 17: Shower system pipe for retrofitting (Order-nr. 48514000)\*
- 18: Shower system pipe for retrofitting (Order-nr. 48515000)\*
- 19: Special Spanner (Order-nr. 19377000)\*
- 20: Socket Spanner (Order-nr. 19332000)\*
- 21: GROHE TurboStat cartridge 1/2" (Order-nr. 47175000)\*
- 22: Spacer (Order-nr. 27180000)\*
- 23: Shower arm for shower systems (Order-nr. 14047000)\*
- 24: GROHE EasyReach tray (Order-nr. 26362LN1)\*

\* Optional accessories